

## How to get your GPA

1. Go to [https://www.flvc.org/CCRE/hs\\_accessbf.jsp](https://www.flvc.org/CCRE/hs_accessbf.jsp)
2. Log in. If you do not know your Florida Student Identifier Number use your SSN with no dashes or spaces and add an 'X' at the end.
3. Scroll to MY PROGRESS to the **"GRADE POINT AVERAGE (GPA) REQUIREMENTS"** section. Make sure your name still appears in the screen under **STUDENT INFORMATION**.
4. If you need to make the screen smaller to show your name and your GPA click the **CTRL** key and the **-** key until it is small enough on the screen

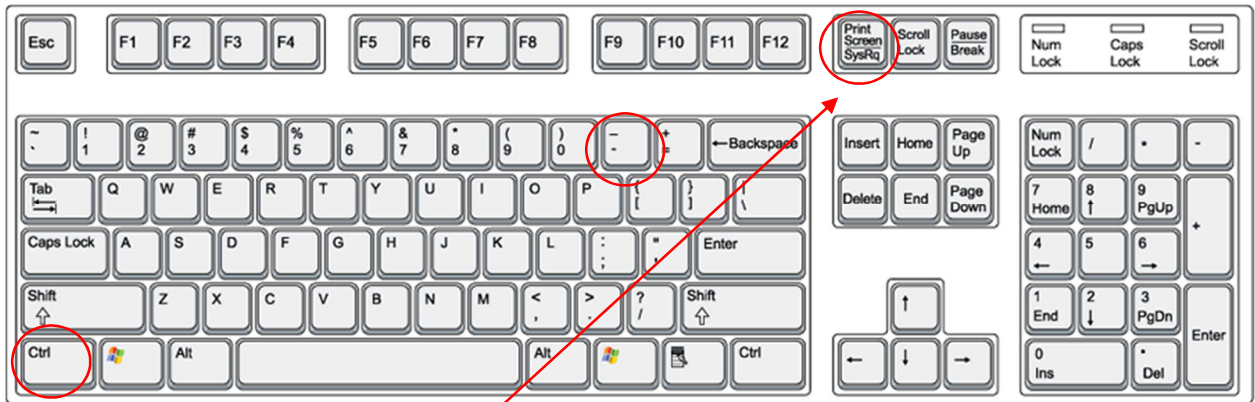

5. Then click the **Print Screen** on the keyboard. The image is now loaded to your clipboard.

**STUDENT INFORMATION**

Name: [Redacted]  
Enrolled School: [Redacted]  
Graduation Year: [Redacted]  
Privacy Block  
Evaluation Last Updated: 10/29/2014

**MY PROGRESS**

College & Career Readiness Evaluations

Select an evaluation below to see your progress towards meeting the requirements. Keep in mind, these plans represent a combination of requirements, including the State's minimum requirements for a 24-credit standard diploma, Bright Futures Scholarships course requirements, and State University System course requirements. Please read the [evaluation descriptions](#) to find the plan that best meets your needs. Also, your school may have additional requirements, diploma options, and designations that are not listed here. We recommend reviewing the [academic advisement flyer](#) available from the Florida Department of Education and speaking with your school counselor for additional information.

[College Prep](#) | [Career Prep](#) | [College and Career Prep](#) | [Standard Prep](#) | [Bright Futures Scholarship Evaluations](#)

Subject Area	Required Course Years	Credit Hours Applied	Missing Credits
English	4.00	4.00	
Mathematics	2.00	2.00	
Algebra I	1.00	0.00	1.00
Geometry	1.00	0.00	1.00
Biology I	1.00	0.00	1.00
Natural Science-EO Science	2.00	2.00	
US Government	.50	.50	
US History	1.00	1.00	
Economics	.50	.50	
World History	1.00	1.00	
Fine Arts/Musical Arts	1.00	1.00	
Physical Education	1.00	.50	.50
Vocals Language	2.00	2.00	
Academic Electives	3.00	3.00	
Vocational Program	3.00	1.00	2.00
<b>TOTALS</b>	<b>24.00</b>	<b>18.50</b>	<b>5.50</b>

Vocational Program: **AEROSPACE TECHNOLOGIES** 8600080  
\* At least one credit must be completed through on-line learning.

**GRADE POINT AVERAGE (GPA) REQUIREMENTS**

Required Unweighted GPA for Graduation: 2.0

Recommended for Career and Non-competitive College Admission: 2.5 [Earned]

Recommended for Competitive College and University Admission: 3.5

**4.00**

**SUMMARY OF MISSING ACHIEVEMENTS**

\* Visit Program Req Hist Mat

Course Title	Course Number	Level	Credit	Grade	Applied
ELECTRONICS FUNDAMENTAL I	EE2010	10	50	B	
Year 2012-2013 Term 4					
FIT LIFESTYLE DESIGN	HE2010	10	50	A	PL
Year 2013-2014 Term 4					
LIBERAL ARTS MATH I	MGF105	11	50	A	AE
INTRO TO PSYCHOLOGY	PSY2012	11	50	A	AE
Year 2013-2014 Term 5					
LIBERAL ARTS MATH II	MGF105	11	50	A	MA
Year 2013-2014 Term 6					
ENG NON III	100300	11	50	A	EN
RESEARCH I	170030	11	50	A	EN
Year 2013-2014 Term 7					
THE HUMANITIES	HUM2020	11	50	A	EN
INTERMEDIATE ALGEBRA	MAT1033	11	50	A	MA
MUSIC THEORY	MUT1111	11	50	A	PF
ENG NON II	100300	11	50	A	EN
RESEARCH I	170030	11	50	A	EN
Year 2013-2014 Term 8					
INTRO TO LITERATURE	LIT1000	11	50	A	EN
COLLEGE ALGEBRA	MAT1095	11	50	A	MA
Year 2013-2014 Term 9					
INTRO SUR TO 1877	AMH100	11	50	A	AH
INTRO TO LITERATURE	LIT1000	11	50	A	EN
COLLEGE ALGEBRA	MAT1095	11	50	A	MA
MUSIC THEORY II	MUT1112	11	50	A	PF

6. Open Word and click the **Ctrl** key and the **V** key to paste the image in a Word document. You may save the document in Word or PDF and upload it to the Web page.